

Welcome to Omaha

Prepared for Project Silicon Heartland

January 2023



Regional Economic Development Partnership

Full Service economic development organizations working together to increase business, investment and employment in the Greater Omaha Area.

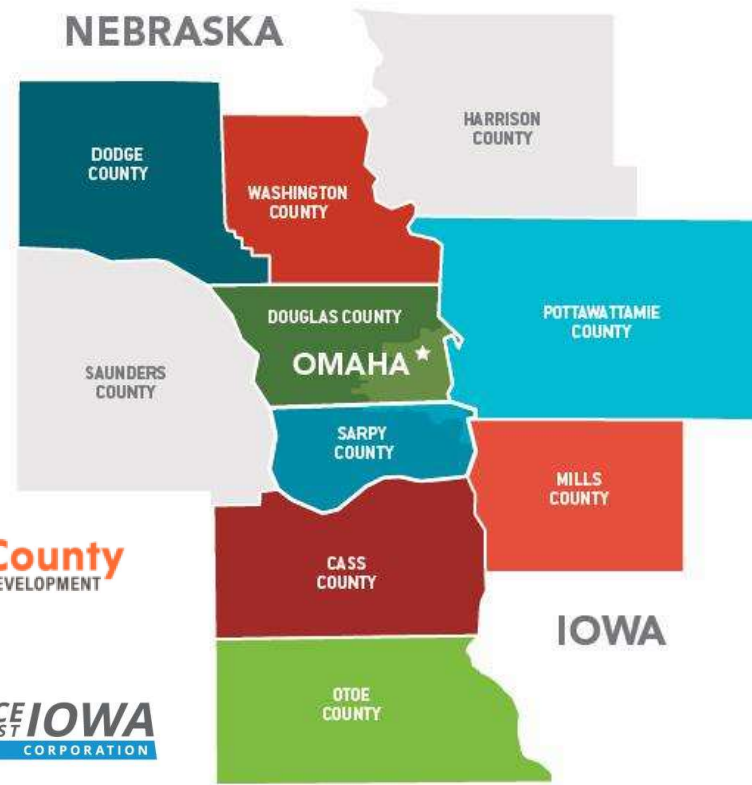

Central US Location



Omaha By The Numbers

Population

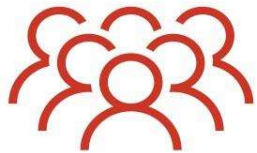

1,004,771

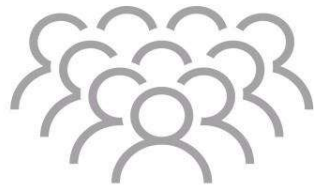

Growing to **1.1 MILLION** people
by the end of 2035²

Age³

YOUTHFUL



34% 24 years of age or younger.

MEDIAN AGE



Omaha: 36.1

U.S.: 38.2



PROJECTED GROWTH 2010-2035²

% Change since 2010

Omaha
20.2%

U.S.
18.5%

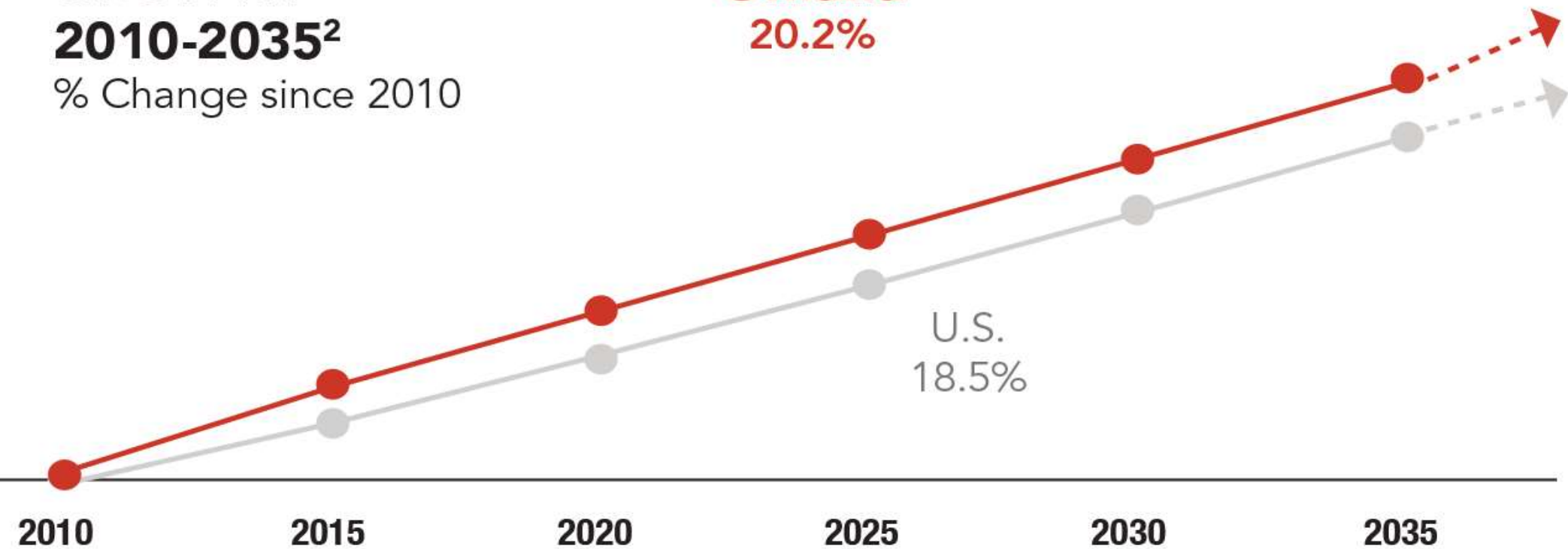

² U.S. Census Bureau, 2014-2018 American Community Survey 5-Year Estimates

RANKINGS

#2 America's Best Midsize Cities, SmartAsset – 2020

#2 Best Cities for Renters, Forbes - 2021

#3 The Best Cities to Relocate to in America, Best Places – 2020

#4 Top States by Projects Per Capita (Nebraska), Site Selection - 2021

#5 Cities with the Best Work-Life-Balance, SmartAsset - 2021

#6 Best States for 2021, U.S. News - 2021



EMPLOYMENT GROWTH¹

% Change since 2007

489,812 Total Jobs
38,541 New Jobs

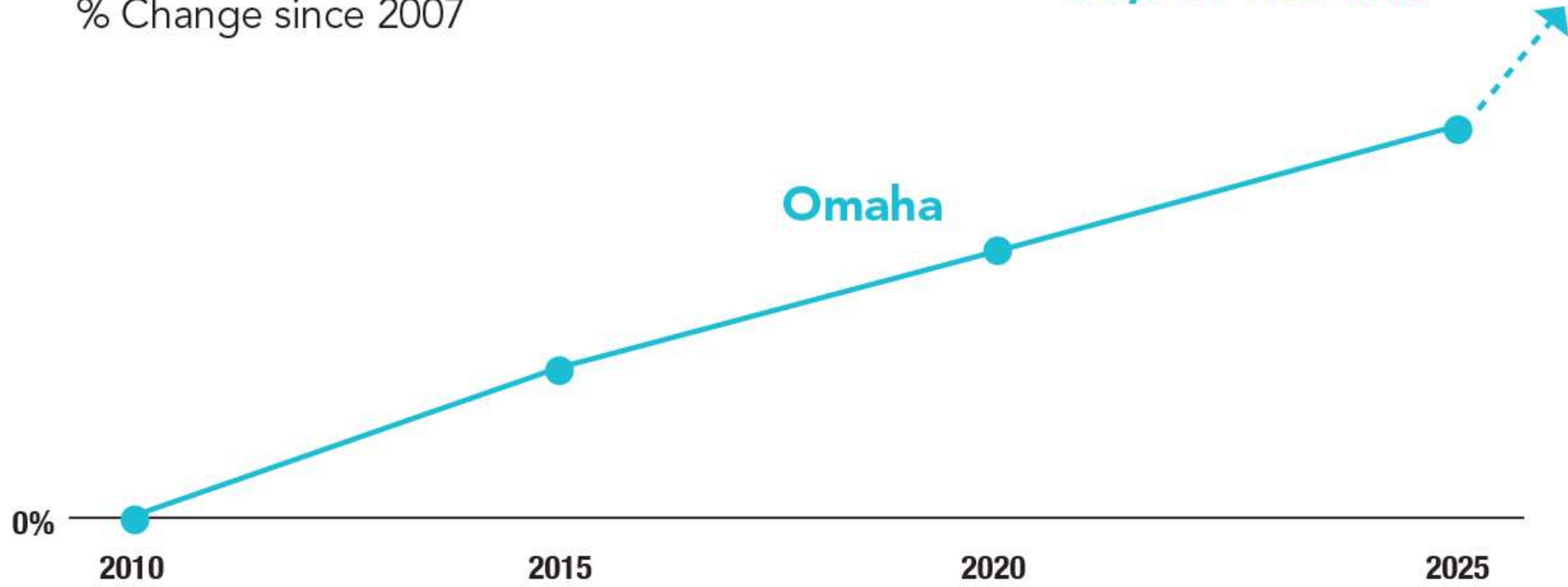

¹ U.S. Bureau of Labor Statistics, LAUS & CPS, 2007-2020

GDP GROWTH % OF CHANGE 2013-2019

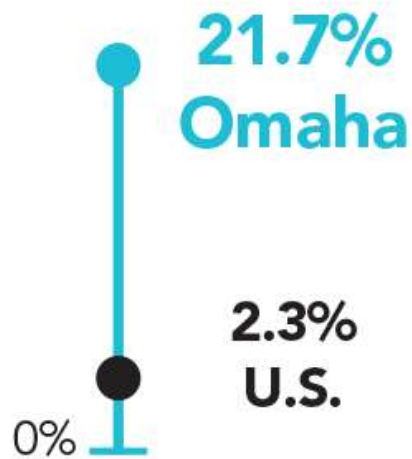

**FINANCE &
INSURANCE**



**HEALTH CARE &
SOCIAL ASSISTANCE**

COST OF DOING BUSINESS

Omaha is 12% better than the national average.

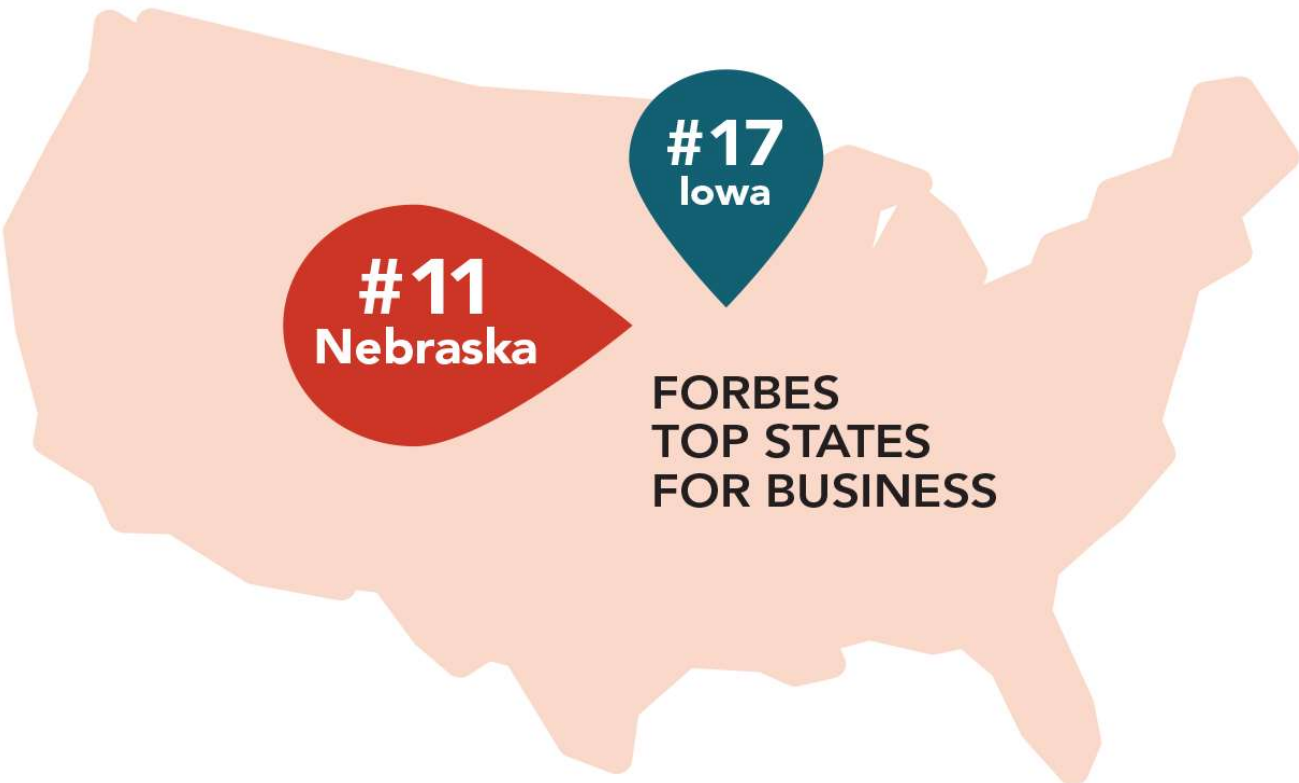

Dr Eric Thompson, University of Nebraska Lincoln, 2021 Barometer



COMPANIES TINY TO TITAN FLOURISH HERE

*Industry - From our **strong business climate**, to our first-class resources, we're proud to cultivate an environment ideally suited for companies wishing to start, grow or expand operations.*

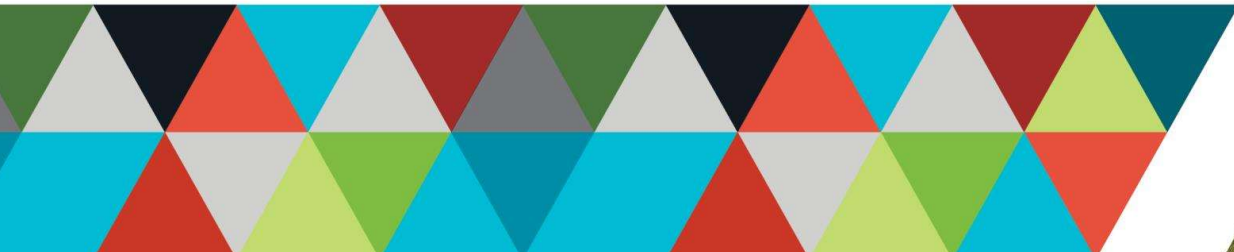

FORTUNE 500

Peter Kiewit Sons' Inc. #313

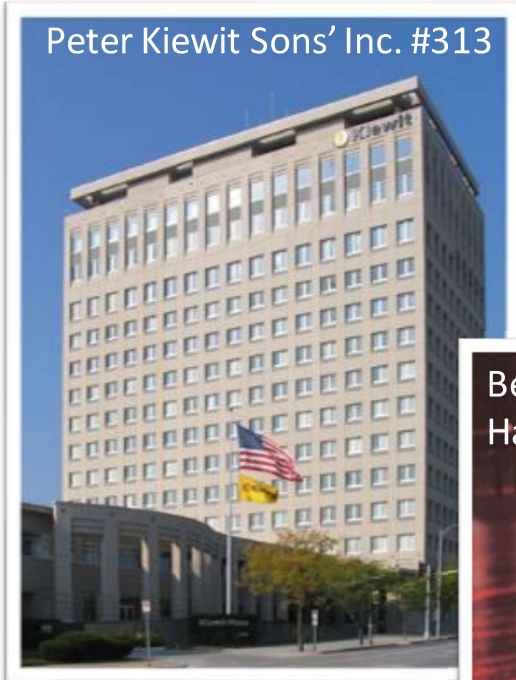

Berkshire Hathaway, Inc. #7



Mutual of Omaha #324



Union Pacific Railroad #163

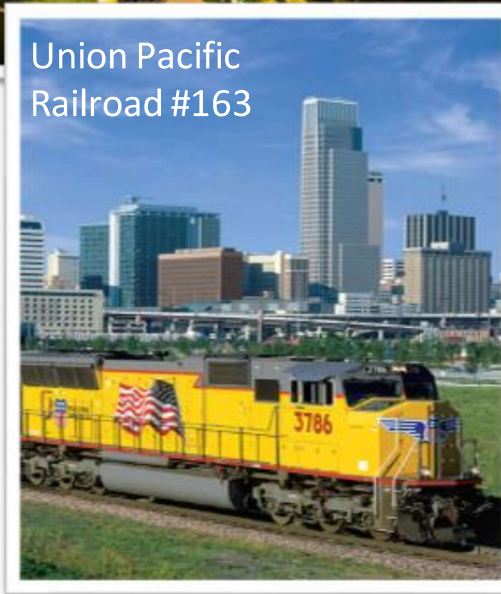

FORTUNE 1000



Green Plains #870



Valmont #750



Werner Enterprises #892

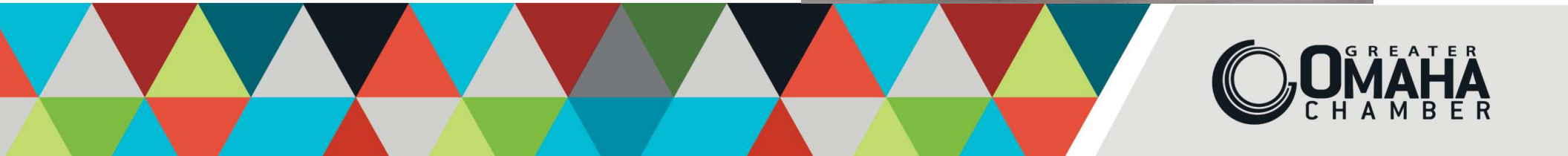

MAJOR SECTORS

Agribusiness

The core of who we are – a leader in food, fuel and water industries

Military & Defense

Home to more than 65 defense-related companies and Offutt Air Force Base

Financial Services

With one of the highest density clusters – our business climate provides the perfect mix to thrive

Manufacturing/Supply Chain/Logistics

Our central location is the prime position to move people or products.

Life Science

Home to nationally acclaimed medical centers and one of four biocontainment units in the U.S.

ANCHOR COMPANIES

Financial

ACI Worldwide
CSG International
First National Bank
Fiserv
PayPal
Charles Schwab

Insurance

Pacific Life
Physicians Mutual
Woodmen of the World

Technology

Gallup
Verizon Media Group
Facebook
Google
LinkedIn

Architect

DLR Group
HDR Inc
Leo A. Daly

Agribusiness/Supply Chain

Cargill
ConAgra Brands
Kellogg's
Novozymes

START-UPS

Buildertrend
Flywheel
Hudl
Sojern
D3 Banking
OpsCompass
Retail Aware
Proxibid
Spreatail
Quantum Workplace
Tigerpaw Software
ATS Secured
Election Systems and Engineering



MANUFACTURING AND LOGISTICS

Move your produce from here to anywhere.

- Food manufacturing is **2.5x more concentrated** than the national average
- Truck transportation is **2.2x more concentrated** than the national average
- Plastic Manufacturing is **1.25x more concentrated** than the national average
- Ag Chemical Manufacturing is **2.5x more concentrated** than the national average
- Rail transportation is **7x larger** than the national average

Foreign Trade Zones

- Access to our two foreign-trade zones (19 - Omaha and 59 - Lincoln) assists importers and encourages efficient international trade by reducing, deferring or even eliminating duties on goods



MANUFACTURING AND LOGISTICS - Talent

We're Built to Build.



- **High School diploma attainment is 92%**, 3% higher than the national average

- **33,000+** employed in manufacturing

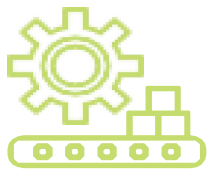

- **29,000+** employed in transportation & warehousing

- Right to work state



MANUFACTURING AND LOGISTICS

Central Location

- Immediate proximity to Interstates 29 and 80, which puts 47 of the 48 continental United States within 2 days trucking.
- National and international air transportation with approximately 88 daily departures.
- It's easy to get materials to and from the rest of the country, with three Class 1 providers trafficking through Greater Omaha.



MANUFACTURING AND LOGISTICS



MANUFACTURING AND LOGISTICS

Amazon
Dollar General
Costco (Lincoln Premium Poultry)
WholeStone Farms
Airlite Plastics
Greater Omaha Packing CO.
OSI Industries
Malnove, Inc
Hormel d.ba. Papillion Foods
Omaha Steaks
Omaha Standard Palfinger
3M
Werner
Lozier



DATA CENTERS

We don't need a valley. We have a Silicon Prairie all our own. With one of the nation's lowest TCO, we are home to a wide slate of shovel-ready sites – low cost, reliable green energy and a skilled IT workforce.

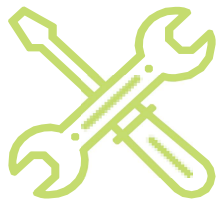

Approximately **\$6 Billion invested** in Data Centers region-wide, either current, proposed or under construction. *

Central US Location offers excellent telecom connectivity to major national markets and minimizes commercial flight times for company personnel.



DATA CENTERS

A collection of industry giants with Data Centers in the region.

ACI Worldwide

CenturyLink

CyrusOne

Ensono

Facebook

Fidelity Investments

Fiserv

First National Technology Solutions

Google

Interpublic Group

LightEdge

Mutual of Omaha

1623 Farnam

Scott Data Center

TierPoint

Travelers Companies

Union Pacific

US Stratcom Global Operation Center

Verizon Media/Yahoo!

The logo for Fiserv, featuring the word "fiserv." in a bold, orange, lowercase sans-serif font.The logo for CyrusOne, consisting of a stylized grey sphere icon to the left of the word "CyrusOne" in a blue sans-serif font.The Google logo, with the word "Google" in its signature multi-colored font.The logo for the Greater Omaha Chamber, featuring a circular icon with a stylized "C" and the words "GREATER OMAHA CHAMBER" in a bold, black, uppercase sans-serif font.

OFFUTT AIRFORCE BASE

Offutt AFB is the second largest area employer in the State of Nebraska

- Nearly 10,000 active military and DoD Civilians
- 21,000 dependents and retired military reside in Greater Omaha
- 557th Weather Wing
- 55th Wing
- U.S. Strategic Command
- Joint POW/MIA Accounting Command



UNITED STATES STRATEGIC COMMAND

USSTRATCOM

One of ten unified commands with a mission of Global Deterrence

- Space Operations
- Global Strike
- Missile Defense
- Intelligence, Surveillance, Reconnaissance (ISR)
- Global Command & Control (C2)
- Information Operations
- Combating Weapons of Mass Destruction

SAVVY, SOPHISTICATED TALENT.

Talent – Our workforce totaling more than 500,000 not only possesses the education and qualities employers are looking for, but also encompasses the Midwest work ethic.





TALENT

- 1.3 Million People Within a 60-Minute Drive (750,000 Workforce)
- Labor force participation rate of 70.6%, higher than the national average of 63.3%

TALENT

HIGH SCHOOL GRADUATES

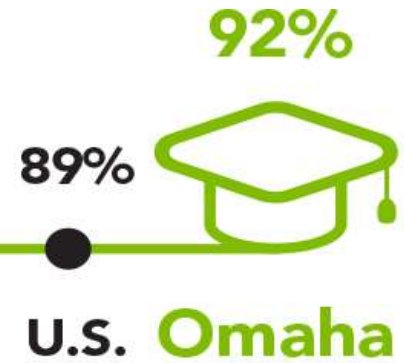

BACHELOR'S DEGREE

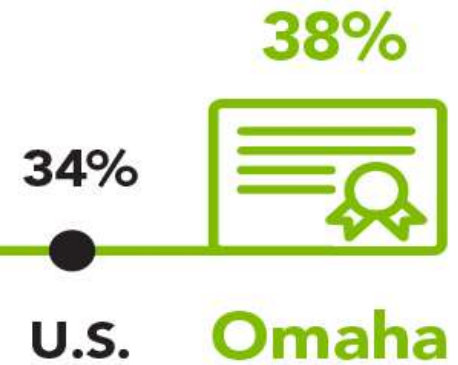

TALENT



INDUSTRY LOCATION QUOTIENT (LQ)

Greater Omaha's Manufacturing Industry Breakdown								
NAICS	Industry	Current		Historical		10-Year Forecast		
		Employment	Location Quotient	Total Employment Change Over Last 5 Years	Average Annual % Change in Employment	Total Approx. Repl Demand	Total Growth Demand	Avg Annual Growth Percent
311	Food Manufacturing	15,749	2.80	1,847	2.5%	18,263	-403	-0.3%
312	Beverage and Tobacco Product Manufacturing	220	0.22	-65	-5.1%	278	11	0.5%
313	Textile Mills	12	0.03	-14	-14.0%	9	-2	-2.3%
314	Textile Product Mills	200	0.52	-21	-1.9%	176	-27	-1.4%
315	Apparel Manufacturing	93	0.22	-58	-9.2%	72	-19	-2.2%
316	Leather and Allied Product Manufacturing	73	0.69	16	5.2%	60	-12	-1.7%
321	Wood Product Manufacturing	862	0.60	183	4.9%	857	-57	-0.7%
322	Paper Manufacturing	1,133	0.92	-36	-0.6%	1,023	-115	-1.1%
323	Printing and Related Support Activities	2,399	1.61	-77	-0.6%	1,843	-490	-2.3%
324	Petroleum and Coal Products Manufacturing	97	0.25	-18	-3.4%	71	-15	-1.6%
325	Chemical Manufacturing	2,375	0.82	-32	-0.3%	2,145	-116	-0.5%
326	Plastics and Rubber Products Manufacturing	2,407	0.97	148	1.3%	2,331	-162	-0.7%
327	Nonmetallic Mineral Product Manufacturing	1,594	1.12	-89	-1.1%	1,542	-91	-0.6%
331	Primary Metal Manufacturing	205	0.16	-47	-4.0%	162	-31	-1.6%
332	Fabricated Metal Product Manufacturing	2,312	0.46	98	0.9%	2,208	-117	-0.5%
333	Machinery Manufacturing	3,284	0.86	-471	-2.6%	2,871	-245	-0.8%
334	Computer and Electronic Product Manufacturing	850	0.23	107	2.7%	602	-108	-1.3%
335	Electrical Equipment, Appliance, and Component Manufacturing	359	0.27	-30	-1.6%	345	-13	-0.4%
336	Transportation Equipment Manufacturing	1,158	0.19	-68	-1.1%	1,072	-51	-0.4%

In the Manufacturing industry (NAICS 310) as a whole, Greater Omaha has an LQ of 0.86, meaning there are a proportional number of employees in this industry than you would expect in a region of this size.

JobsEQ® (Data as of 2019.)

INDUSTRY WAGE COMPARISONS

Greater Omaha Manufacturing Wages (Hourly)											
SOC	Occupation Title	Mean	Entry Level	Experienced	Percentiles					Mean	
					10%	25%	50% (Median)	75%	90%	Nebraska	USA
11-1021	General and Operations Managers	\$49.97	\$23.54	\$63.19	\$20.76	\$29.39	\$42.31	\$62.19	\$90.33	\$47.85	\$59.15
11-2022	Sales Managers	\$57.02	\$28.08	\$71.48	\$25.27	\$34.45	\$49.20	\$70.20	\$99.01	\$52.72	\$68.12
11-3031	Financial Managers	\$57.94	\$30.49	\$71.67	\$27.36	\$37.35	\$50.42	\$69.82	\$97.46	\$55.99	\$70.93
11-3051	Industrial Production Managers	\$51.63	\$33.62	\$60.64	\$31.61	\$38.45	\$48.30	\$61.95	\$77.31	\$48.77	\$55.34
11-9041	Architectural and Engineering Managers	\$61.95	\$44.12	\$70.86	\$41.40	\$50.40	\$62.43	\$73.15	\$82.49	\$59.62	\$73.52
13-1023	Purchasing Agents, Except Wholesale, Retail, and Farm Products	\$32.81	\$20.42	\$39.01	\$19.18	\$23.51	\$30.63	\$40.68	\$49.49	\$30.87	\$33.50
13-1198	Project Management Specialists and Business Operations Specialists, All Other	\$36.80	\$21.49	\$44.46	\$19.07	\$26.20	\$35.02	\$45.62	\$54.55	\$35.90	\$38.57
13-2011	Accountants and Auditors	\$35.01	\$22.44	\$41.29	\$20.99	\$25.51	\$30.47	\$39.75	\$52.46	\$33.86	\$38.23
15-1256	Software Developers and Software Quality Assurance Analysts and Testers	\$44.66	\$30.73	\$51.62	\$28.72	\$35.39	\$44.42	\$54.38	\$61.96	\$43.66	\$53.66
17-2071	Electrical Engineers	\$43.75	\$31.20	\$50.02	\$28.81	\$36.11	\$43.49	\$50.49	\$58.51	\$44.10	\$49.75
17-2112	Industrial Engineers	\$42.04	\$29.75	\$48.18	\$28.15	\$33.54	\$41.00	\$49.40	\$59.26	\$40.19	\$44.55
17-2141	Mechanical Engineers	\$39.51	\$27.65	\$45.44	\$25.55	\$31.86	\$37.78	\$46.33	\$57.77	\$39.91	\$44.97
17-3023	Electrical and Electronic Engineering	\$29.60	\$20.56	\$34.12	\$18.40	\$24.65	\$29.47	\$34.11	\$39.75	\$29.25	\$31.85

The following table shows the average annual hourly wages for occupations in the Manufacturing industry by percentile. The average entry and experienced level wages and mean are also included.

JobsEQ® (Data as of 2019.)

INDUSTRY LABOR AVAILABILITY

Greater Omaha Potential Manufacturing Labor Force						
SOC	Occupation Title	Current Employment	Unemployed	Employment Extended	Unemployment Extended	Potential Candidates per Opening Ratio
11-1021	General and Operations Managers	8,539	123	20,200	276	4,331
11-2022	Sales Managers	1,467	31	7,328	104	1,497
11-3051	Industrial Production Managers	548	9	12,151	170	558
11-9041	Architectural and Engineering Managers	433	4	3,465	38	437
11-9198	Personal Service Managers, All Other; Entertainment and Recreation Managers, Except Gambling; and Managers, All Other	2,502	32	11,048	180	2,533
13-1023	Purchasing Agents, Except Wholesale, Retail, and Farm Products	934	24	4,234	54	959
13-1071	Human Resources Specialists	2,513	56	7,613	132	2,569
13-1081	Logisticians	560	8	1,438	24	568
13-1161	Market Research Analysts and Marketing Specialists	2,286	52	6,946	134	2,338
13-1198	Project Management Specialists and Business Operations Specialists, All Other	2,591	63	4,791	66	2,655
13-2011	Accountants and Auditors	5,098	68	4,646	77	5,166
15-1256	Software Developers and Software Quality Assurance Analysts and Testers	5,055	58	8,882	155	5,112
17-2071	Electrical Engineers	423	7	2,369	32	430
17-2072	Electronics Engineers, Except Computer	191	3	2,052	30	195
17-2112	Industrial Engineers	630	8	2,435	36	319
17-2141	Mechanical Engineers	607	9	1,114	15	616
17-3023	Electrical and Electronic Engineering Technologists and Technicians	323	7	4,150	105	330

Greater Omaha has an ample labor supply in all occupations necessary for operating new manufacturing facilities. The potential candidate/opening ratio shows a new employer will be able to draw from a large pool of potential employees to select an ideal worker.

UNIVERSITIES & COLLEGES

Greater Omaha and the surrounding communities offer some of the top colleges and universities in the region including:

- 19 colleges and universities with a combined enrollment of almost 67,000 students
- Two internationally recognized medical schools — the University of Nebraska Medical Center and Creighton University Medical Center
- There are over 50 post-secondary institutions within a 200-mile radius of Lincoln and Omaha; this feeds into the region's talent pipeline.
- 112,000 college students within a 50-mile radius.

UNIVERSITY OF NEBRASKA - OMAHA

UNO has six colleges (Arts & Sciences, Business Administration, Communication, Fine Arts & Media, Education, Information Science & Technology and Public Affairs & Community Service) with academic priorities in STEM, Early Childhood/Child Welfare, Sustainability, Doctoral/Research and Global Engagement.

- 80% Recent grads reported having one or more internships, practica or jobs while at UNO
- Consecutively ranked by Military Times as the No. 1 University for Military Friendliness (2015-2017).

* Current information available

UNIVERSITY OF
Nebraska
Omaha



Total Enrollment: 15,153

2017/2018* Academic Year Graduates:

- 2,221 Bachelors
- 879 Masters
- 41 Doctorates



UNIVERSITY OF NEBRASKA - LINCOLN

The University of Nebraska–Lincoln, chartered in 1869, is an educational institution of international stature. Nebraska, a member of the Big Ten Conference and the Big Ten Academic Alliance, is made up of nine colleges and is classified within the Carnegie “R1: Doctoral Universities – Highest Research Activity” category. Nebraska is also a land-grant university and a member of the Association of Public and Land-grant Universities (APLU).

UNIVERSITY OF
Nebraska
Lincoln



Total Enrollment: 25,820

2017/2018* Academic Year Graduates:

- 4,032 Bachelors
- 941 Masters
- 398 Doctorates

* Current information available



CREIGHTON UNIVERSITY

Creighton University is a private institution founded in 1878 and offers a top-ranked education in the Jesuit tradition for people who want to contribute something meaningful to the world. It has over 8,900 undergraduate, graduate and professional students enrolled at their urban campus. Recent graduates report a success rate of 98 percent; they are employed, continuing their education or in a volunteer program.

Creighton has nine schools and colleges that deliver a powerful education with program in the arts and sciences, law, business and health sciences. On campus, there is an 11 students to 1 faculty ratio.

* Current information available



Total Enrollment: 8,910

2017/2018* Academic Year Graduates:

- 1,010 Bachelors
- 426 Masters
- 812 Doctorates



BELLEVUE UNIVERSITY

Routinely ranked among the nation's top military-friendly institutions, the University serves students at its main campus in Bellevue, Nebraska, just outside of Omaha. Bellevue University is accredited by the Higher Learning Commission (hlcommission.org), a regional accreditation agency recognized by the U.S. Department of Education.

The University offers over 80 degrees in high growth career fields as well as certificates for career advancement. Student's learning is advanced through several specialized entities within the school; The Center for Cybersecurity Education, The Center for Project Management and The Human Capital Lab.

* Current information available



Total Enrollment: 9,621

2017/2018* Academic Year Graduates:

- 1,816 Bachelors
- 959 Masters
- 4 Doctorates



METROPOLITAN COMMUNITY COLLEGE

Metropolitan Community College is a comprehensive, full-service public community college supported by the taxpayers of Dodge, Douglas, Sarpy and Washington counties. Its purpose is to provide high quality educational programs and services, primarily in career preparation and general education, to people of all ages and educational backgrounds.

MCC offers more than 100 one- and two-year career programs in business administration, computer and office technologies, culinary arts, industrial and construction technologies, nursing and allied health, social sciences and services, and visual and electronic technologies, as well as academic transfer programs.

* Current information available



Total Enrollment: 14,913 (includes non-degree seeking, and transfer students)



METROPOLITAN COMMUNITY COLLEGE

MCC's Center for Advanced Manufacturing \$10.5 Million Expansion

New labs, equipment and courses in:

- Precision Machine Technology
- Mechanical Drafting Technology
- Electrical/Mechanical Maintenance & Technology
- Manufacturing, Power, and Process Operations Technology
- Welding Technology



IOWA WESTERN COMMUNITY COLLEGE

Iowa Western Community College in Council Bluffs is a fully accredited educational institution offering more than 80 career, college-transfer and technical programs. Nestled on 250 beautiful acres in Iowa's Loess Hills, Iowa Western provides students with a "big-school" atmosphere in a quiet setting.

Iowa Western offers a variety of activities that help students enjoy a well-rounded college experience. The Arts Center, which has garnered national awards for its architectural beauty, is home to theater, dance and musical productions in addition to an exciting national touring season.

The college's radio station, 89.7 The River, broadcasts live from the Council Bluffs campus and offers a popular alternative rock music format. KIWR is one of the top radio stations in the Omaha Metro area. Iowa Western's student center features culinary arts classrooms, a wireless access library and full-service cafeteria. The college's suite-style housing complex and modern apartments give students a chance to encounter the ultimate college experience on a safe and easily accessible campus. The campus in Council Bluffs is now home to 1,400 residential students.



Iowa Western is home to
1,400 residential students



SOUTHEAST COMMUNITY COLLEGE

Southeast is a vibrant two-year public institution of higher education serving a primary area of 15 counties in southeast Nebraska. SCC offers multiple locations and continues to expand its online opportunities. With high-quality career/technical and academic programs and very affordable tuition and fees, SCC provides students with tremendous opportunities to create their futures through the obtainment of new knowledge, skills and awareness.

Their unique blend of career/technical programs will provide students with the skills necessary to be successful in the workforce.

* Current information available



SCC has more than 60 career/tech and transfer program options to choose from, as well as degree, diploma and certificate options.



BE AN EMPLOYER OF CHOICE



HEARTLAND
WORKFORCE
SOLUTIONS

A proud partner of the American Job Center network

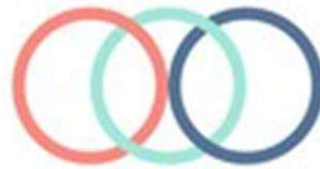

JOB SHARE CONNECT
MATCH PARTNERS. EXPAND TALENT.



GROW
GREATER OMAHA WORKLAB

Building your company's talent pool is one of the most important tasks faced by employers across the nation.



INFRASTRUCTURE AND TRANSPORTATION

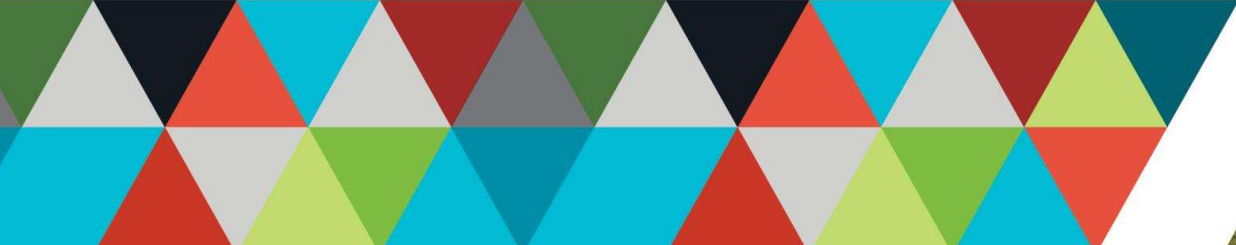

UTILITIES - OPPD

Omaha Public Power District (OPPD) retail rates provides an average of 16 percent below the national levels.

- 6 cents per kWh or below, with no general rate increases through 2021.
- Currently over 1,000 MW of renewables producing 40 percent of the utility's retail sales, with a target of 50 percent.
- Pursuing a goal of net zero carbon production by 2050.
- A green rate that provides market rate pricing and 100-percent renewable solutions for large scale projects with a minimum of 20 MW.
- 99.986 percent system-wide reliability average over the last 10 years.

* Source OPPD



NATURAL GAS

Partnership is served by two gas utilities:

Metropolitan Utilities District (MUD)

Publicly owned

Serves Omaha and portions of Sarpy County.

Black Hills Energy

Nebraska: Serves portions of Sarpy, Washington and Cass Counties.

Iowa: Serves portions of Pottawattamie, Mills and Harrison Counties.

WATER

Abundant supply of water for industrial and commercial uses.

The current system operated by Metropolitan Utilities District (MUD) consists of:

- 334 MGD capacity of the water system
- 97 MGD average utilization
- 223 MGD peak utilization
- 111 MGD excess capacity (factoring in peak utilization)
- Six reservoirs
- 2,200 miles of water mains

WASTEWATER

Abundant capacity for industrial and commercial uses

- The current system operated by the City of Omaha consists of:
- 70 MGD capacity of the water system
- 59 MGD average utilization
- 65 MGD peak utilization
- 5 MGD excess capacity (factoring in peak utilization)

TELECOMMUNICATIONS

- 100 GIG Connectivity Options – Local Access and Long Haul
- Diversity of carriers (40+) including seven of the top 13 in the world with multiple POPs
- Omaha is the center point of most cross country fiber routes.
- Multiple Tier 1 and Tier 2 long-haul IXC carriers with diverse, redundant fiber networks
- Direct, multiple routing to Europe and Asia



100 GIG Connectivity Options

Local Access and Long Haul

Multiple POPs

Multiple Tier 1 and Tier 2 long-haul IXC carriers with diverse, redundant fiber networks

Direct, multiple routing to Europe and Asia

100-GIG bandwidth capacity on an ICB basis for most carriers

Carrier neutral hotel – 40+ carriers including seven of the top 13 in the world

TRANSPORTATION

Centered: A Key Transportation Hub

Located strategically in the Heartland, we're served by a ring of interstate highways, railroads, motor freight and air connectivity that improves productivity, reduces downtime and increases quality of life.



We have direct flights to more than 33 major cities across the country, including direct flights to: San Francisco, Los Angeles, New York City, Atlanta and Washington D.C.



Trucks can access more than 90% of the continental U.S. within two days.



Approximately 70.1 billion pounds of cargo are enplaned annually.



Reduce transportation costs with quick-access to an intermodal facility and shipping available from three Class-I railroads.

Nonstop service to 33 destinations.

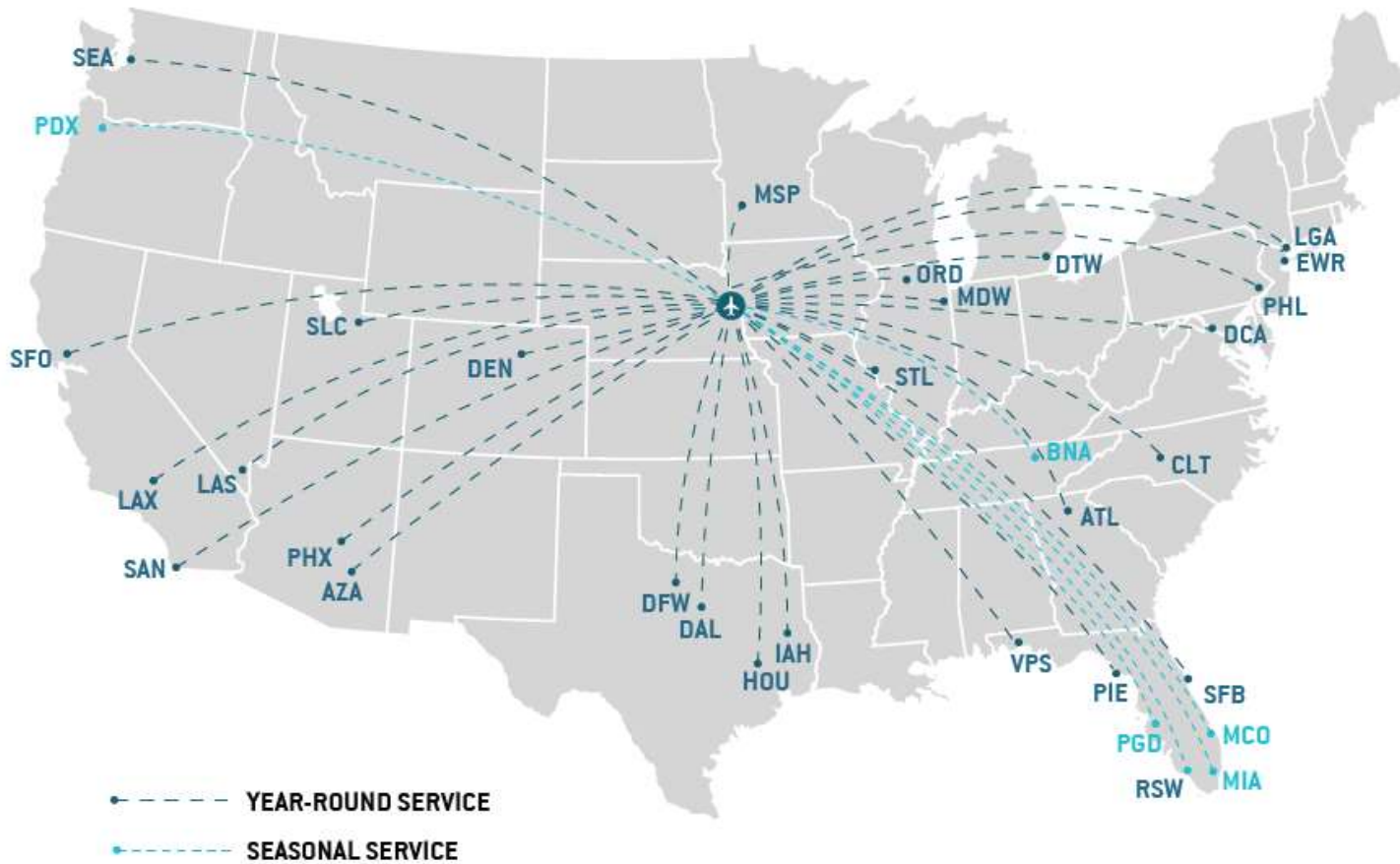



Upper Level

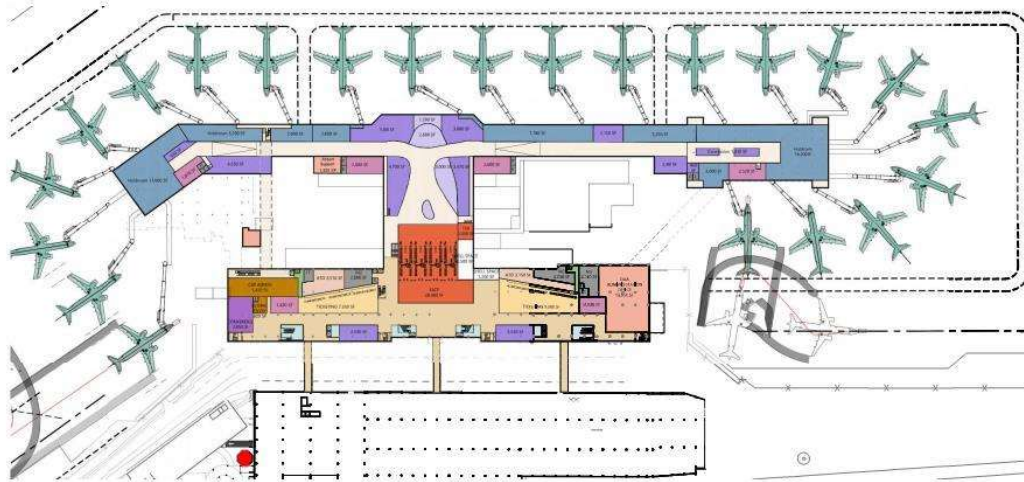

Lower Level

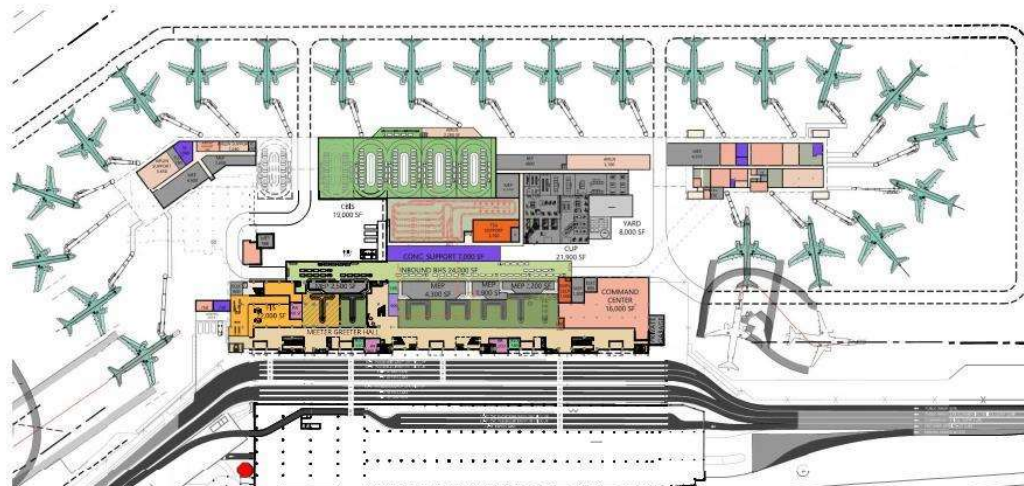

Eppley Airfield Terminal Reconstruction

- Begins 2023
- \$600 Million
- Double terminal size to between 650,000 – 700,000 SF
- Improved Amenities
- Combined Security Entrance



QUALITY OF LIFE

When you're here, you're home.





Enthusiastic, full
living with a serious
cool factor



COST OF LIVING

Our cost of living is 8.1% below the national average.



Median home prices are approximately 27% less than the national average. Omaha \$200,700 vs U.S. \$274,600

One-bedroom Apartments rent 21% below average. Omaha \$766 vs U.S. Top 100 Cities \$965

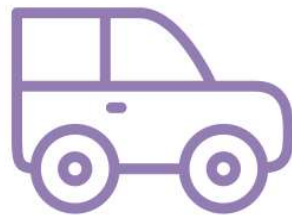

Our average one-way commute time is 20.2 minutes.

Omaha By The Numbers

COST OF LIVING

Omaha has a great cost of living with a score of 95.9 which puts it -4.1% below the national average

Minneapolis	102.9	+2.9% above national average
Dallas	103.5	+3.5%
Chicago	123.3	+23.3%
Los Angeles	149.3	+49.3%
San Francisco	194.1	+94.1%

\$57,809

\$53,504

PER CAPITA INCOME



BIG TIME ATTRACTIONS



Omaha's Henry Doorly Zoo and Aquarium is the #3 best zoo in the country.

Home to 17,00 animals and 962 species. Attracts close to 2 million animal lovers annually.



We're home of the NCAA College World Series and host to many other marquee national events. Not to mention the home of four college sports teams, AAA baseball, USHL hockey, pro indoor football and our very own boxing world champion.

Along with our bustling local scene, we host huge events for some of the biggest names in music.



Cher
Chris Stapleton
Katy Perry
Elton John

Jason Mraz
Justin Timberlake
Pink
Lizzo

Luke Bryan
Panic at the Disco
Dropkick Murphys



OUTDOOR RECREATION

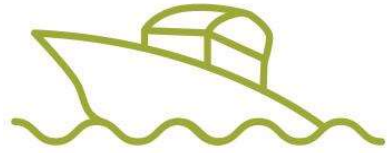

Skydive, boat or fish – we'll exceed every expectation.

85+ miles of paved, interconnected trails for walking jogging and biking.

30+ lake communities

14 state parks within 40 miles

60+ public and private golf courses throughout the region.

WORLD CLASS DINING



From international fare to down-home cooking, we are a foodie's delight.

You could try a different restaurant for dinner every night, and it would still take you about four years to start the rotation over again.

1,531 restaurants, 290 bars and 21 breweries, wineries and distilleries are sure to satisfy any craving. (InfoGroup , 2020)

Some of our Favorites:

801 Chophouse
Pitch Pizzeria
Modern Love
M's Pub
Yoshitomo

J. Gilbert's
Blue Sushi
Plank
J Coco
Le Voltaire

Jam's
Hook & Lime
16 Block
Kitchen Table
Boiler Room

ARTS AND ENTERTAINMENT



Our contemporary arts centers and award-winning museums, offer the creative embrace artists need to flourish.

Bemis Center for Contemporary Arts
Great Plains Black History Museum
Hot Shops Art Center
KANEKO
The Union for Contemporary Art

El Museo Latino
Harvester Artspace Lofts
Joslyn Art Museum
Love's Jazz and Arts Center
The Durham Museum



Broadway plays and musicals, local productions and acoustical wonders surround us.

BLUEBARN Theatre Omaha Community Playhouse
Orpheum Theater The Rose Theater
Holland Performing Arts Center – home to the Omaha Symphony and Opera Omaha

Live stages, big and small, attract acts from across the street, across the nation and across the world.

CHI Health Center Omaha Mid-America Center
Slowdown Sokol Auditorium
Stir Concert Cove The Waiting Room
Westfair Amphitheater

WORKFORCE PROGRAMS

Nebraska Worker Training Program (LB 1337)

- Administered by the Nebraska Department of Labor
- Grants to assist firms in the retraining and upgrading skills for existing employees.
- Flexible program which requires a match of at least one dollar of employer funds for each dollar of state funds.
- Competitive applications may provide for a greater employer match but is not required. In-kind (matching) contributions considered may include wages paid, space rental or equipment.

Intern Nebraska

- Connects college students, junior and senior high school students with employers from across the state.
- Program offers financial assistance to companies creating new internship opportunities for college students.
- Businesses can receive up to 50 percent reimbursement for the intern, up to \$5,000 per internship.

OMAHA
WE DON'T COAST™
WE WIN

